

1 in = 425 feet

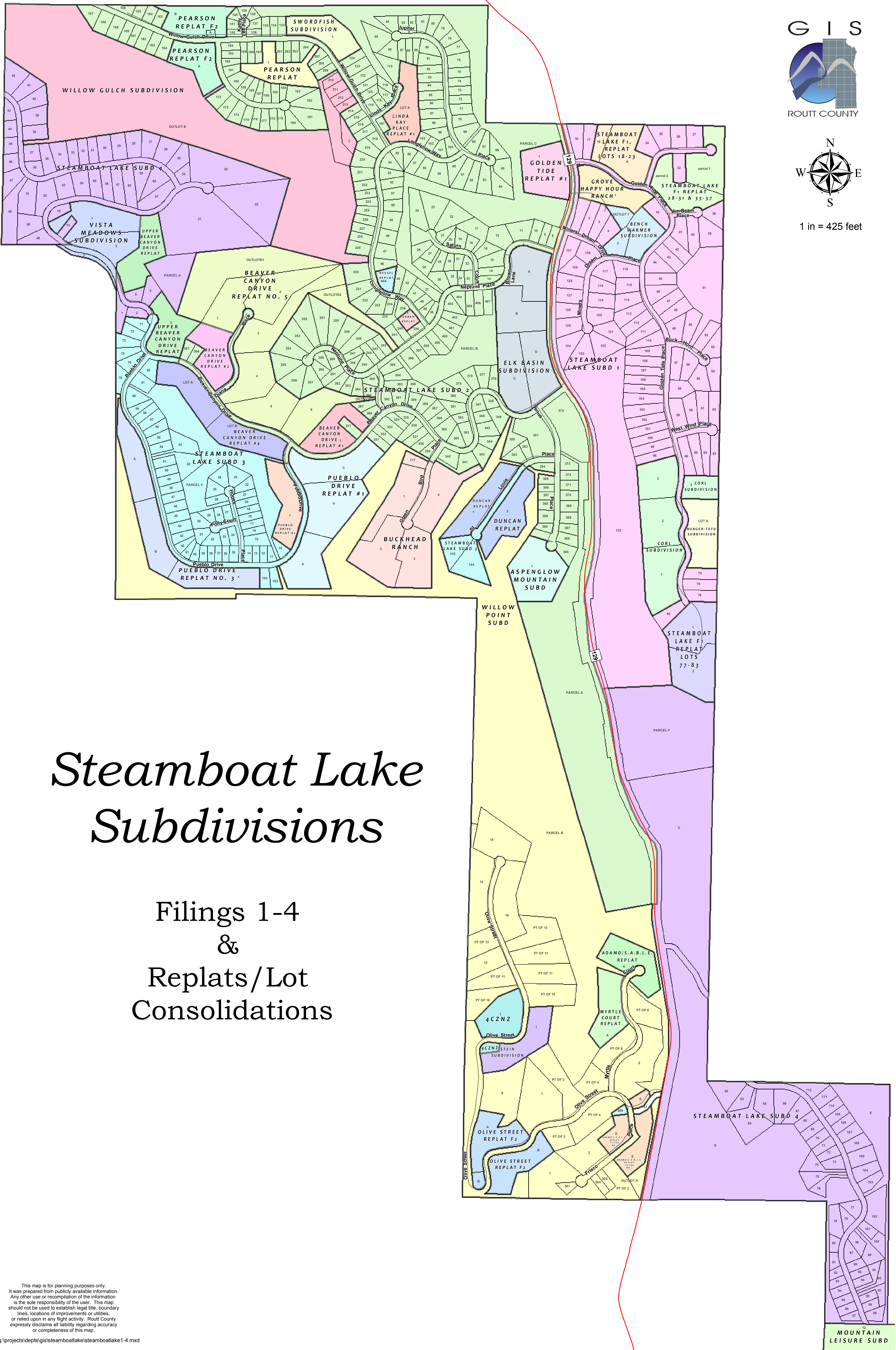

Steamboat Lake Subdivisions

Filings 1-4
&
Replats/Lot
Consolidations

This map is for planning purposes only. It was prepared from publicly available information. Any other use or compilation of the information is the sole responsibility of the user. This map should not be used to establish legal title, boundary lines, locations of improvements or utilities, or relied upon in any fight activity. Rout County expressly disclaims all liability regarding accuracy or completeness of this map.